

# APPLICATION GUIDE

## GROUT PROTECTION

### APPLICATION BY HAND

FOR ALL TYPES OF CEMENT BASED WALL & FLOOR GROUT BETWEEN GLAZED CERAMICS & GLAZED & UNGLAZED PORCELAIN.

# ECO Pro tec

Most grouting is water resistant and not waterproof so it absorbs moisture. It is normally moisture carrying dirt particles that will discolour grout. The following is a guide to help ensure that treated surfaces remain protected and easy to maintain for many years.

### THREE STEP INSTALLATION INSTRUCTION OVERVIEW (SEE PAGE TWO FOR REFURBISHING EXISTING)

#### CEMENT & GROUT RESIDUE REMOVER

#### INITIAL CLEANING OF NEWLY INSTALLED SURFACES

ECOPROTEC CEMENT & GROUT RESIDUE REMOVER – Cleans & removes cement & grout residues

1

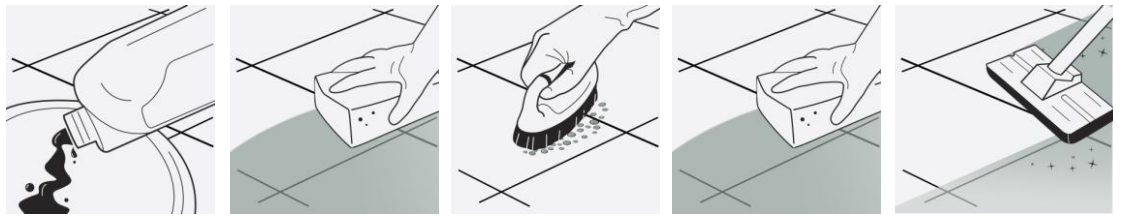

**STEP 1.**  
Dilute EcoProtec Cement and Grout Residue Remover 1:1 with cool water.

**STEP 2.**  
Apply liberally and spread over surface of the tiles.

**STEP 3.**  
If necessary, agitate with A scrubbing brush or rotary scrubbing machine and leave to react for 10-15 mins.

**STEP 4.**  
Keeping wet with additional EcoProtec Cement & Grout Residue Remover solution.

**STEP 5.**  
Mop up and rinse thoroughly with clean water several times and Allow surfaces to dry. (24 hours)

#### NATURAL FINISH STONE SEALER

#### PROTECT AGAINST STAINS

ECOPROTEC NATURAL FINISH STONE SEALER - protects against water, oil and grime.

2

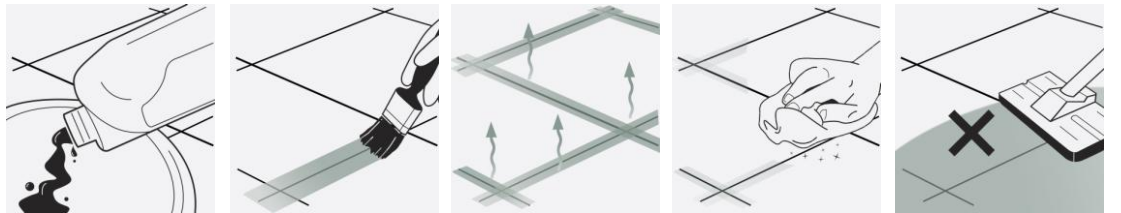

**STEP 1.**  
Pour sealing solution into a separate container.

**STEP 2.**  
Apply to the joints and allow the sealer to absorb

**STEP 3.**  
Leave to dry. Approx 20-30 minutes.

**STEP 4.**  
Buff excess sealer from the surface of the tile. Machines can be used.

**STEP 5.**  
Keep surface dry for 24 hours following application.

#### NATURAL STONE & PORCELAIN AFTER CARE CLEANER

#### REGULAR AFTERCARE

ECOPROTEC NATURAL STONE & PORCELAIN AFTER CARE CLEANER – Ph Neutral

3

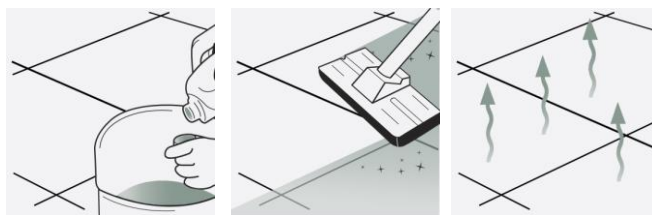

**STEP 1.**  
Dilute 1 capful of cleaner per litre of warm water.

**STEP 2.**  
Mop surfaces with the Solution. Do not rinse.

**STEP 3.**  
Allow to dry. Do not walk on surface during drying time. (20 minutes).

Approx 40 washes per litre of cleaner.



Telephone +44(0)1823 666213  
Email info@ecoprotec.co.uk  
Web www.ecoprotec.co.uk  
Address tone estate, wellington TA21 0AN UK



Stone  
Federation  
Great Britain



# APPLICATION GUIDE

## GROUT PROTECTION

### APPLICATION BY HAND

FOR ALL TYPES OF CEMENT BASED WALL & FLOOR GROUT BETWEEN GLAZED CERAMICS & GLAZED & UNGLAZED PORCELAIN.

# ECO Pro tec

### EQUIPMENT REQUIRED:

LTP Tools – Paint brush, scrubbing brush, deck brush, claw brush, buffing cloths, buckets, sponges, mops.

Ensure that any sensitive surfaces not to be cleaned are properly covered and protected before beginning. Ensure that gloves, eye protection are worn at all times.

## 1 CLEANING AND REFURBISHING – used and heavily soiled surfaces

- Before sealing the grout joints and surface of the tiles should be thoroughly cleaned. Old layers of sealer, residues from aftercare cleaners and deposits must be removed.
- Depending on the levels of dirt, dilute Stone & Tile Intensive Cleaner 1 : 3 with water and apply to the surface using a sponge and leave to sit on the surface of the tiles and grout for 5 – 10 minutes.
- Agitate the joints and the surface of the tiles using a white emulsifying pad or stiff scrubbing. Use a grout brush on the joints.
- Continue to scrub while adding clean water. Remove released residues using a sponge and water.
- Rinse thoroughly with clean water to remove any remaining residues.
- Allow the surface to dry for a minimum of 12 hours before applying the protective seal.
- For the removal of other types of dirt see the table below.

### OTHER TYPES OF DIRT

Care product residues, oil, grease and dirt

ECOPROTEC Stone & Tile Intensive Cleaner

Mould & mildew.

ECOPROTEC External Paving Cleaner

## 2 PROTECTIVE SEAL TREATMENTS

- **ECOPROTEC Natural Finish Stone Sealer** will render the surface water and oil repellent.
- This product will help prevent staining, aid cleaning and simplify the removal of stains.
- **ECOPROTEC Natural Finish Stone Sealer** will not greatly alter the character of treated surfaces.
- There are no health concerns once the product has properly cured.
- Both are breathable so can be used on surfaces that are still slightly damp or have no damp proof course.
- Cleaned appropriately using **ECOPROTEC Natural stone and porcelain after care cleaner** we would suggest topping up the protective treatment every 3 – 4 years.
- Both are suitable for internal and external use.

NB. Always test products on an inconspicuous area before general application. Surfaces that are non absorbent or saturated with moisture cannot be treated. **ECOPROTEC Natural Finish Stone Sealer** is an impregnating sealer that needs to fully absorb. Any un-absorbed sealer should be buffed off using a micro-fibre cloth or machine with white pad to remove the excess. Some grouts may be darker after application.

## 3 AFTERCARE



### ECOPROTEC Natural stone and porcelain after care cleaner

**High quality every day after care cleaner floor wash that is suitable for interior and exterior use**

A gentle cleaner especially formulated to clean natural stone, porcelain and ceramic without damaging the grout, tile or protective treatments, leaving surfaces with a fresh clean fragrance. Suitable for use on both sealed and unsealed, polished and unpolished surfaces. **1 ltr of product will wash a 20 m<sup>2</sup> surface 40 times.**

NB. Always follow detailed instructions on the product labels. Avoid using steam cleaners, normal detergents or strong bleach cleaners on sealed surfaces as they will gradually remove the protective seal.

*This information is offered without guarantee. The material should be used so as to take account of the local conditions and the surfaces to be treated. In case of doubt, the product should be tried out in an inconspicuous area*



Telephone +44(0)1823 666213  
 Email info@ecoprotec.co.uk  
 Web www.ecoprotec.co.uk  
 Address tone estate, wellington TA21 0AN UK



Stone  
Federation  
Great Britain

