

APPLICATION GUIDE

POLISHED PORCELAIN (Including Nano Treated)

APPLICATION BY HAND

HIGHLY FIRED, MACHINE POLISHED,
FULL BODIED CLAY TILES.

ECO PRO TEC

Mechanically polished porcelain will normally require a certain level of care. The following is a guide to help ensure that treated surfaces remain protected and easy to maintain for many years.

THREE STEP INSTALLATION INSTRUCTION OVERVIEW (SEE PAGE TWO FOR REFURBISHING EXISTING)

STONE & TILE INTENSIVE CLEANER

INITIAL CLEANING OF NEWLY INSTALLED SURFACES

ECOPROTEC STONE & TILE INTENSIVE CLEANER – Cleans and conditions surfaces before sealing

1

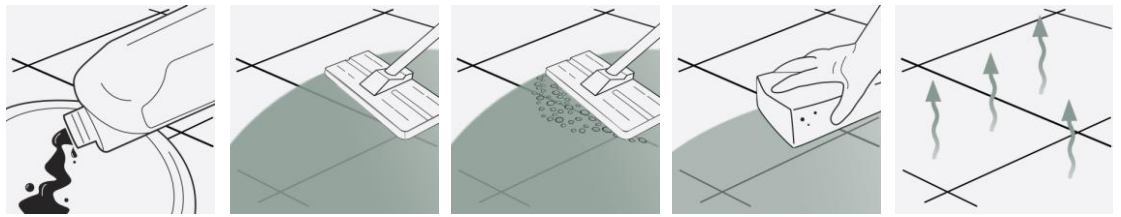

STEP 1.

Dilute solution 1:4 with warm water and apply to the surface.

STEP 2.

Working in manageable areas at a time spread out the solution. Leave for 20 minutes.

STEP 3.

Add a little water and then scrub surfaces and grout joints to release dirt and grime. Use white pad and pad holder.

STEP 4.

Sponge up released residues. Rinse with water a second time and sponge again.

STEP 5.

Allow surfaces to dry before allowing traffic or sealing.

POLISHED PORCELAIN SEALER

PROTECT AGAINST STAINS - (apply before and after grouting)

ECOPROTEC POLISHED PORCELAIN SEALER - protects against water, oil and grime

2

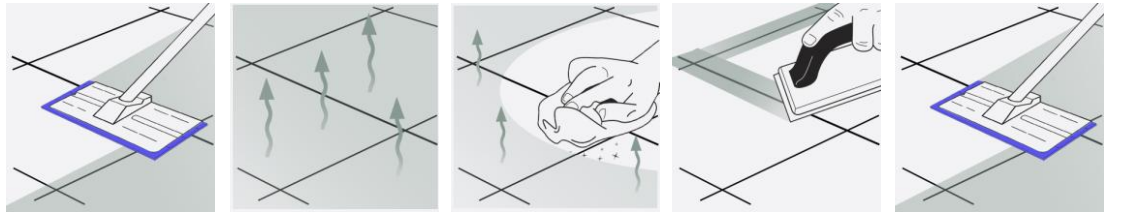

STEP 1.

Before grouting: Apply sealing solution to the surface. Spread out evenly using a sealant applicator pad and pad holder.

STEP 2.

Allow sealer to absorb and dry.

STEP 3.

Remove any residual sealer if still visible after 1 hour by buffing with a micro fibre cloth or buffing machine

STEP 4.

Leave sealer to cure overnight before grouting the joints. Clean off grout residues and leave to dry.

STEP 5.

Once fully dry apply a final coat of sealer covering the joints as well. Leave to dry. Buff of any residual sealer if still visible after 1 hour. Do not allow traffic for 3 hours

NATURAL STONE & PORCELAIN AFTER CARE CLEANER

REGULAR AFTERCARE

ECOPROTEC NATURAL STONE & PORCELAIN AFTER CARE CLEANER – Ph Neutral

3

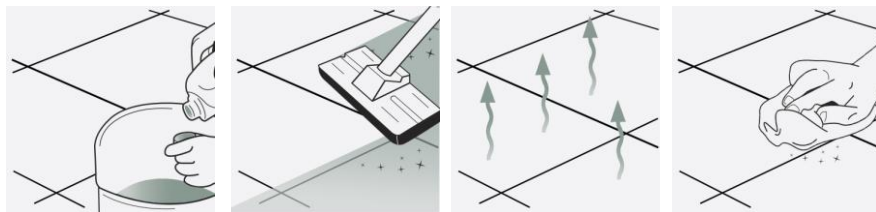

STEP 1.

Dilute 1 capful of cleaner per litre of warm water.

STEP 2.

Mop surfaces with the Solution. Do not rinse.

STEP 3.

Allow to dry. Do not walk on surface during drying time. (20 minutes).

STEP 4.

For best results buff polished surfaces with a microfiber cloth to finish

Approx 40
washes
from 1 litre
of cleaner



Telephone +44(0)1823 666213
Email info@ecoprotec.co.uk
Web www.ecoprotec.co.uk
Address stone estate, wellington TA21 0AN UK



Federation
Stone
Great Britain



APPLICATION GUIDE

POLISHED PORCELAIN (Including Nano Treated)

APPLICATION BY HAND

HIGHLY FIRED, MACHINE POLISHED,
FULL BODIED CLAY TILES.

ECO PRO TEC

EQUIPMENT REQUIRED:

LTP Tools - 4pc pole, pad holder, sealant applicator, white emulsifying pad, deck brush, claw brush, buffing cloths, buckets, sponges, mops.

Ensure that any sensitive surfaces not to be cleaned are properly covered and protected before beginning. Ensure that gloves, eye protection and suitable protective clothing are worn at all times.

1 CLEANING AND REFURBISHING – used and heavily soiled surfaces

- Before re sealing the polished porcelain it should be thoroughly cleaned. Old layers of sealer, residues from aftercare cleaners and deposits must be removed from the surface and the pores of the porcelain with **ECOPROTEC Stone & Tile Intensive Cleaner**.
- To help remove years of ground in dirt and grime dilute **Stone & Tile Intensive Cleaner** 1:1 with water and apply to the surface. This should be left for 5-30 minutes depending upon the level of dirt.
- Agitate the surface using a white pad, scrubbing brush or rotary scrubbing machine and leave for a further 5 minutes.
- Continue to scrub while adding clean water. Remove released residues using a sponge and water or extract using a wet vac.
- Rinse thoroughly with clean water to remove any remaining residues.
- Surfaces should be thoroughly dry before sealing, a minimum of 12 hours.
- For the removal of other types of dirt see the table below.

OTHER TYPES OF DIRT

Care product residues, oil, grease and dirt

ECOPROTEC Stone & Tile Intensive Cleaner

Wax and acrylic layers, paint and epoxy grout residues

ECOPROTEC Graffiti Remover

Stubborn Stains & residual grout

ECOPROTEC Cement & Grout Residue Remover

2 PROTECTIVE SEAL TREATMENTS

- ECOPROTEC Polished Porcelain Sealer** will render the surface water and oil repellent.
- This product will help prevent staining, aid cleaning and simplify the removal of surface stains.
- Provides an invisible barrier of protection that will not greatly alter the surface character.
- There are no health concerns once the product has properly cured.
- This sealer is micro porous and so can be used on surfaces that have no damp proof course.
- Cleaned appropriately using **ECOPROTEC Natural stone and porcelain after care cleaner** we would suggest topping up the protective treatment every 3 – 4 years.
- Suitable for internal and external use.

NB. Always test products on an inconspicuous area before general application. Surfaces that are non absorbent or saturated with moisture cannot be treated. **ECOPROTEC Polished Porcelain Sealer** is an impregnating sealer that needs to fully absorb. Any un-absorbed sealer should be buffed off with a micro-fibre cloth or machine with white pad to remove the excess. Some polished porcelains may be darker after application.

3 AFTERCARE



ECOPROTEC Natural stone and porcelain after care cleaner

High quality every day after care cleaner floor wash that is suitable for interior and exterior use

A gentle cleaner especially formulated to clean natural stone, porcelain and ceramic without damaging the grout, tile or protective treatments, leaving surfaces with a fresh clean fragrance. Suitable for use on both sealed and unsealed, polished and unpolished surfaces. **1 ltr of product will wash a 20 m² surface 40 times.**

NB. Always follow detailed instructions on the product labels. Protect acid sensitive surfaces from contact with acidic substances. Do not use abrasive materials on polished porcelain. Avoid using steam cleaners, normal detergents or strong bleach cleaners on sealed surfaces as they will gradually remove the protective seal. Some factory nano sealed porcelains are sensitive to acid based residual grout removers.

This information is offered without guarantee. The material should be used so as to take account of the local conditions and the surfaces to be treated. In case of doubt, the product should be tried out in an inconspicuous area



Telephone +44(0)1823 666213
 Email info@ecoprotec.co.uk
 Web www.ecoprotec.co.uk
 Address tone estate, wellington TA21 0AN UK



Federation
Stone
 Great Britain

